

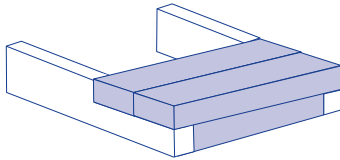

INSTALLATION GUIDE

SLEEPER STEPS

1



Set the number 1 side into 125 mm Channel. Cut the crib so that it fits into the slots in the side walls. Place the treads. Back fill under steps. You can put a concrete footing for the back sides to sit on.

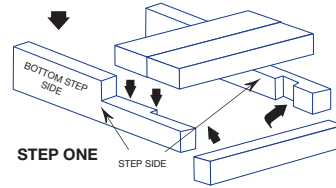

2

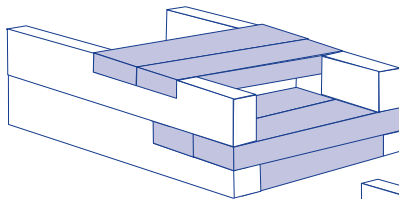

Set the number 2 side into 125 mm Channel. Cut the crib so that it fits into the slots in the side walls. Place the treads. Back fill under steps.

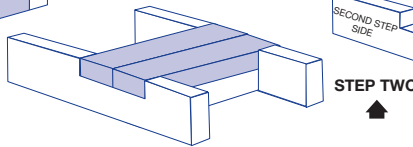

3

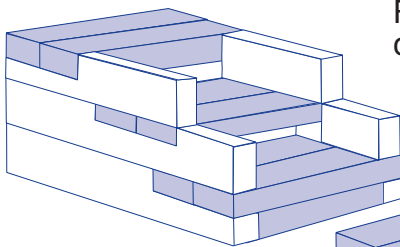

Follow Steps 1 and 2 until all step components are installed.

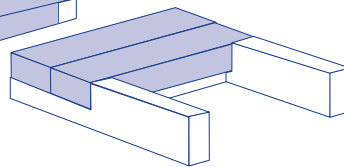

SO EASY TO INSTALL!

Step kits come with 5 components per layer, 2 sides, 2 treads and 1 crib. All sides are labelled with the layers number in the crib cut out. Step kits can be made up to 6 layers high.

Step treads are available in 3 widths i.e. 1.2, 2.0 and 2.4 metres. 1.2 metre treads gives a 1.0 metre opening, 2.0 metre treads give a 1.8 metre opening and 2.4 metre treads gives a 2.0 metre opening.

Steps	Height	Depth of Step Kit
2 high	400 mm	750
3 high	600 mm	1050
4 high	800 mm	1350
5 high	1 metre	1650
6 High	1.2 metres	1950

